



MAST GUIDE SERIES

Specially designed bearings to handle mast movements of industrial trucks. This series will handle heavy radial and shock loads. Thick outer rings permit heavy OD loading. Specially designed seals allow the bearings to operate in adverse environments.

| PEER Bearing No. | MRC Interchange | BCA Interchange | Hoover/NSK Interchange |
|---------------------|--------------------|--------------------|---------------------------|
| MG206FFA | 206-SZZ-16 | MG206FFA | |
| MG206SZZ-16 | | | |
| MG207FFJ | | | |
| MG207FFJA | | | |
| MG207FFWA | | | |
| MG208FFA | 208-SZZ-15 | MG208FFA | |
| MG208SZZ-15 | | | |
| MG209MZZ-1 | | | |
| MG305SZZ-3 | | | |
| MG305SZZ-6 | | | |
| MG305SZZ-7 | 305-SZZ-3 | MG305DD | X421RS |
| MG306SZZ-5 | 305-SZZ-6 | MG305DDA | |
| MG307SZZ-4 | 305-SZZ-7 | | |
| MG307SZZ-9 | 306-SZZ-5 | MG306DD | X555 |
| MG307SZZ-10 | 307-SZZ-4 | MG307FFA | |
| MG307SZZ-14 | 307-SZZ-9 | MG307FFK | X549RS |
| MG307SZZ-18 | 307-SZZ-10 | MG307FF(FFH) | X376RS |
| MG308SZZ-5 | 307-SZZ-14 | | |
| MG309SZZ-1 | 307-SZZ-18 | MG307FFP | |
| MG309SZZ-4 | 308-SZZ-5 | MG308FFA | |
| MG309SZZ-5 | 309-SZZ-1 | | X469 |
| MG311SZZ-1 | 309-SZZ-4 | MG309DDA | X501RS |
| | 309-SZZ-5 | | |
| | 311-SZZ-1 | | |

*Special sizes available upon request

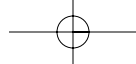

MAST GUIDE SERIES

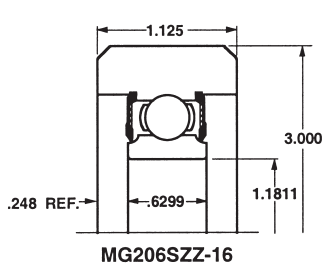

MG206SZZ-16

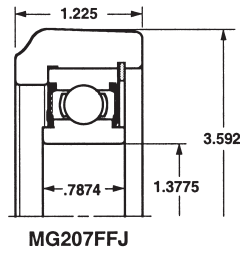

MG207FFJ

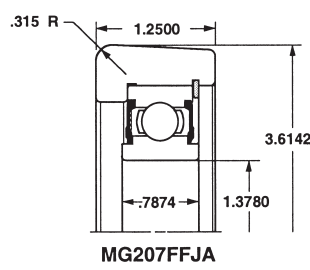

MG207FFJA

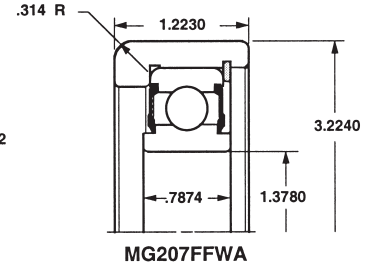

MG207FFWA

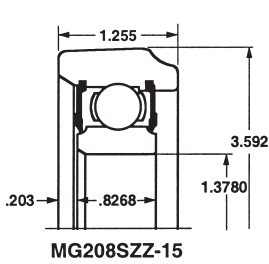

MG208SZZ-15

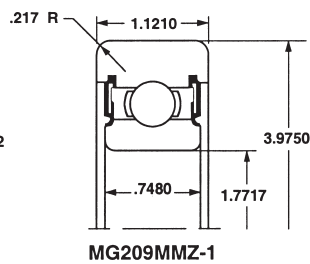

MG209MMZ-1

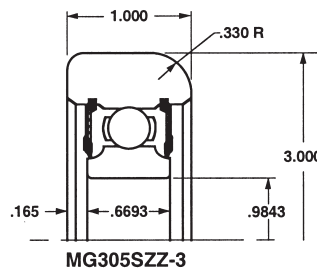

MG305SZZ-3

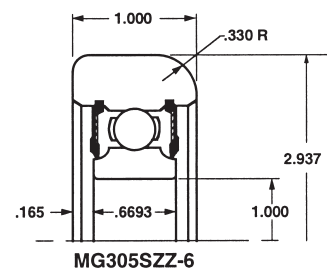

MG305SZZ-6

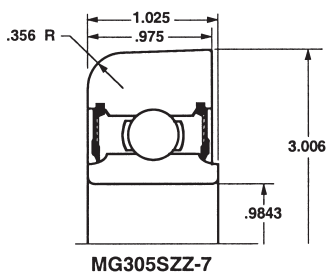

MG305SZZ-7

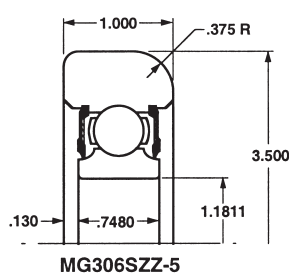

MG306SZZ-5

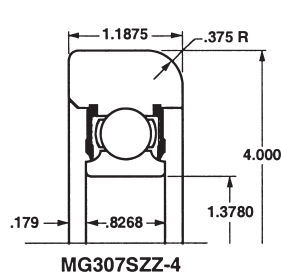

MG307SZZ-4

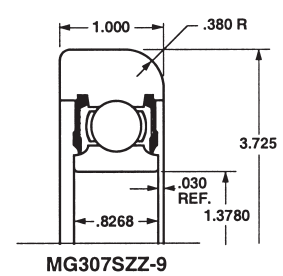

MG307SZZ-9

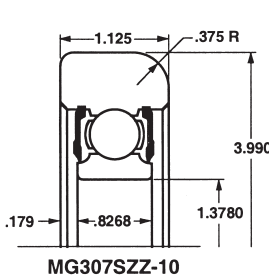

MG307SZZ-10

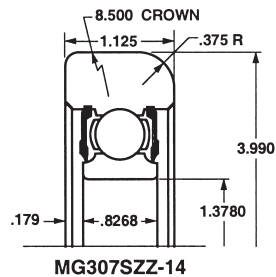

MG307SZZ-14

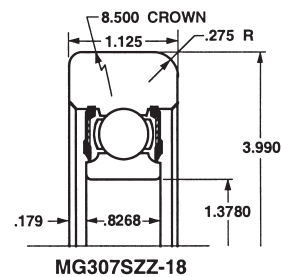

MG307SZZ-18

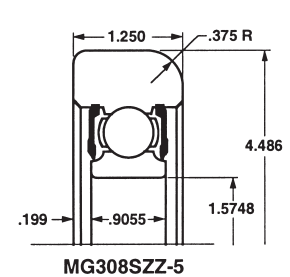

MG308SZZ-5

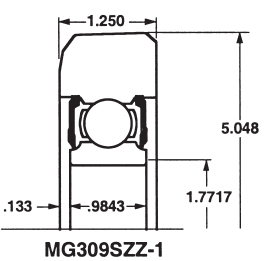

MG309SZZ-1

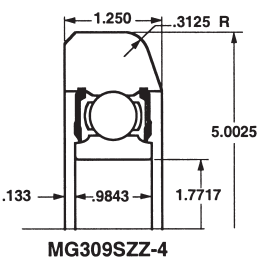

MG309SZZ-4

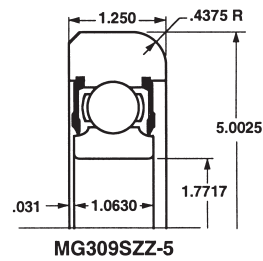

MG309SZZ-5

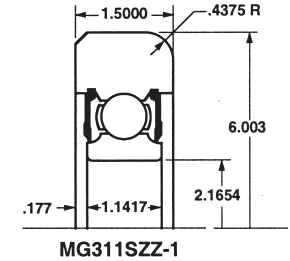

MG311SZZ-1

