

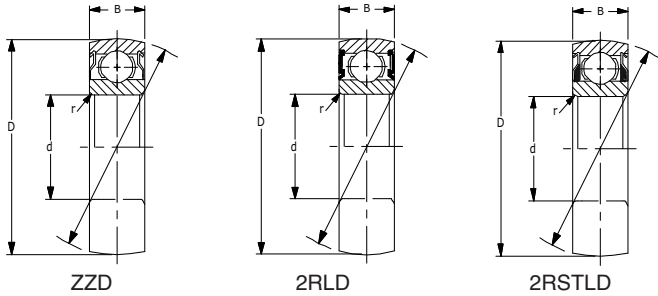

SPHERICAL O.D. "22" SERIES



Standard Conrad series with spherical (rounded) O.D. to allow for self-aligning.

Units: Inches
Metric

Part Number	Bore d		Outer Diameter D		Width B		Radius r			Basic Load Rating		Weight lbs.
	TOL. +0/to		TOL. +0/to		TOL. +0/to		rs min	max radial	max axial	lbf Dynamic C	N. Static Cor	
	Nominal	Minus Shown	Nominal	Minus Shown	Nominal	Minus Shown						
6202-ZZ-22	0.5906	.0003	1.3780	.0050	.4331	.0050	.0236	.0394	.0787	1730	850	.10
	15.000	.0008	35.000	.013	11.000	.127	.600	1.000	2.000	7695	3780	
6202-2RS-22	0.5906	.0003	1.3780	.0050	.4331	.0050	.0236	.0394	.0787	1730	850	.10
	15.000	.0008	35.000	.013	11.000	.127	.600	1.000	2.000	7695	3780	
6202-2RST-22	0.5906	.0003	1.3780	.0050	.4331	.0050	.0236	.0394	.0787	1730	850	.10
	15.000	.0008	35.000	.013	11.000	.127	.600	1.000	2.000	7695	3780	
6203-ZZ-22	.6693	.0003	1.5748	.0050	.4724	.0050	.0236	.0394	.0787	2160	1000	.14
	17.000	.0008	40.000	.013	12.000	.127	.600	1.000	2.000	9608	4448	
6203-2RS-22	.6693	.0003	1.5748	.0050	.4724	.0050	.0236	.0394	.0787	2160	1000	.14
	17.000	.0008	40.000	.013	12.000	.127	.600	1.000	2.000	9608	4448	
6203-2RST-22	.6693	.0003	1.5748	.0050	.4724	.0050	.0236	.0394	.0787	2160	1000	.14
	17.000	.0008	40.000	.013	12.000	.127	.600	1.000	2.000	9608	4448	
6204-ZZ-22	.7874	.0004	1.8504	.0050	.5512	.0050	.0394	.0591	.1181	2900	1410	.23
	20.000	.010	47.000	.013	14.000	.127	1.000	1.500	3.000	12899	6271	
6204-2RS-22	.7874	.0004	1.8504	.0050	.5512	.0050	.0394	.0591	.1181	2900	1410	.23
	20.000	.010	47.000	.013	14.000	.127	1.000	1.500	3.000	12899	6271	
6204-2RST-22	.7874	.0004	1.8504	.0050	.5512	.0050	.0394	.0591	.1181	2900	1410	.23
	20.000	.010	47.000	.013	14.000	.127	1.000	1.500	3.000	12899	6271	
6205-ZZ-22	.9843	.0004	2.0472	.0050	.5906	.0050	.0394	.0591	.1181	3150	1610	.28
	25.000	.010	52.000	.013	15.000	.127	1.000	1.500	3.000	14011	7161	
6205-2RS-22	.9843	.0004	2.0472	.0050	.5906	.0050	.0394	.0591	.1181	3150	1610	.28
	25.000	.010	52.000	.013	15.000	.127	1.000	1.500	3.000	14011	7161	
6205-2RST-22	.9843	.0004	2.0472	.0050	.5906	.0050	.0394	.0591	.1181	3150	1610	.28
	25.000	.010	52.000	.013	15.000	.127	1.000	1.500	3.000	14011	7161	
6206-ZZ-22	1.1811	.0004	2.4409	.0050	.6299	.0050	.0394	.0591	.1181	4370	2320	.43
	30.000	.010	62.000	.013	16.000	.127	1.000	1.500	3.000	19438	10319	
6206-2RS-22	1.1811	.0004	2.4409	.0050	.6299	.0050	.0394	.0591	.1181	4370	2320	.43
	30.000	.010	62.000	.013	16.000	.127	1.000	1.500	3.000	19438	10319	
6206-2RST-22	1.1811	.0004	2.4409	.0050	.6299	.0050	.0394	.0591	.1181	4370	2320	.43
	30.000	.010	62.000	.013	16.000	.127	1.000	1.500	3.000	19438	10319	
6207-ZZ-22	1.378	.0050	2.8346	.0050	.6693	.0050	.0433	.0787	.1378	5770	3150	.64
	35.000	.013	72.000	.013	17.000	.127	1.100	2.000	3.500	25666	14011	
6207-2RS-22	1.378	.0050	2.8346	.0050	.6693	.0050	.0433	.0787	.1378	5770	3150	.64
	35.000	.013	72.000	.013	17.000	.127	1.100	2.000	3.500	25666	14011	
6207-2RST-22	1.378	.0050	2.8346	.0050	.6693	.0050	.0433	.0787	.1378	5770	3150	.64
	35.000	.013	72.000	.013	17.000	.127	1.100	2.000	3.500	25666	14011	
6208-ZZ-22	1.5748	.0050	3.1496	.0050	.7087	.0050	.0433	.0787	.1378	7340	3650	.82
	40.000	.013	80.000	.013	18.000	.127	1.100	2.000	3.500	32649	16236	
6208-2RS-22	1.5748	.0050	3.1496	.0050	.7087	.0050	.0433	.0787	.1378	7340	3650	.82
	40.000	.013	80.000	.013	18.000	.127	1.100	2.000	3.500	32649	16236	
6208-2RST-22	1.5748	.0050	3.1496	.0050	.7087	.0050	.0433	.0787	.1378	7340	3650	.82
	40.000	.013	80.000	.013	18.000	.127	1.100	2.000	3.500	32649	16236	
6209-ZZ-22	1.7717	.0050	3.3465	.0060	.7480	.0050	.0433	.0787	.1378	7350	4150	.90
	45.000	.013	85.000	.015	19.000	.127	1.100	2.000	3.500	32694	18460	
6209-2RS-22	1.7717	.0050	3.3465	.0060	.7480	.0050	.0433	.0787	.1378	7350	4150	.90
	45.000	.013	85.000	.015	19.000	.127	1.100	2.000	3.500	32694	18460	
6209-2RST-22	1.7717	.0050	3.3465	.0060	.7480	.0050	.0433	.0787	.1378	7350	4150	.90
	45.000	.013	85.000	.015	19.000	.127	1.100	2.000	3.500	32694	18460	

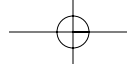

SPHERICAL O.D. "22" SERIES (continued)

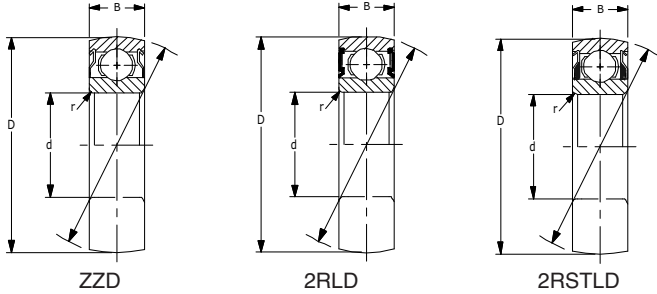

Standard Conrad series with spherical (rounded) O.D. to allow for self-aligning.

Units: Inches
Metric

Part Number	Bore d		Outer Diameter D		Width B		Radius r			Basic Load Rating		Weight lbs.
	TOL. +0/to		TOL. +0/to		TOL. +0/to		rs min	max radial	max axial	Dynamic C	N. Static Cor	
	Nominal	Minus Shown	Nominal	Minus Shown	Nominal	Minus Shown						
6210-ZZ-22	1.9685	.0050	3.5433	.0060	.7874	.0050	.0433	.0787	.1378	7880	4650	1.01
6210-2RS-22	50.000	.013	90.000	.015	20.000	.127	1.100	2.00	3.500	35051	20684	1.01
6210-2RST-22	1.9685	.0050	3.5433	.0060	.7874	.0050	.0433	.0787	.1378	7880	4650	1.01
	50.000	.013	90.000	.015	20.000	.127	1.100	2.00	3.500	35051	20684	1.01
6305-ZZ-22	1.9843	.0004	2.4409	.0050	.6693	.0050	.0433	.0787	.1378	5000	2600	.52
	25.000	.010	62.000	.013	17.000	.127	1.100	2.00	3.500	22241	11565	.52
6305-2RS-22	1.9843	.0004	2.4409	.0050	.6693	.0050	.0433	.0787	.1378	5000	2600	.52
	25.000	.010	62.000	.013	17.000	.127	1.100	2.00	3.500	22241	11565	.52
6306-ZZ-22	1.1811	.0004	2.8346	.0050	.7480	.0050	.0433	.0787	.1378	6550	3650	.78
	30.000	.010	72.000	.013	19.000	.127	1.100	2.00	3.500	29135	16236	.78
6306-2RS-22	1.1811	.0004	2.8346	.0050	.7480	.0050	.0433	.0787	.1378	6550	3650	.78
	30.000	.010	72.000	.013	19.000	.127	1.100	2.00	3.500	29135	16236	.78
6306-2RST-22	1.1811	.0004	2.8346	.0050	.7480	.0050	.0433	.0787	.1378	6550	3650	.78
	30.000	.010	72.000	.013	19.000	.127	1.100	2.00	3.500	29135	16236	.78
6307-ZZ-22	1.3780	.0005	3.1496	.0050	.8268	.0050	.0591	.0906	.1575	7500	4300	1.02
	35.000	.013	80.000	.013	21.000	.127	1.500	2.30	4.000	33361	19127	1.02
6307-2RS-22	1.3780	.0005	3.1496	.0050	.8268	.0050	.0591	.0906	.1575	7500	4300	1.02
	35.000	.013	80.000	.013	21.000	.127	1.500	2.30	4.000	33361	19127	1.02
6307-2RST-22	1.3780	.0005	3.1496	.0050	.8268	.0050	.0591	.0906	.1575	7500	4300	1.02
	35.000	.013	80.000	.013	21.000	.127	1.500	2.30	4.000	33361	19127	1.02
6308-ZZ-22	1.5748	.0005	3.5433	.0060	.9055	.0050	.0591	.0906	.1575	9650	5600	1.41
	40.000	.013	90.000	.015	23.000	.127	1.500	2.30	4.000	42925	24910	1.41
6308-2RS-22	1.5748	.0005	3.5433	.0060	.9055	.0050	.0591	.0906	.1575	9650	5600	1.41
	40.000	.013	90.000	.015	23.000	.127	1.500	2.30	4.000	42925	24910	1.41
6308-2RST-22	1.5748	.0005	3.5433	.0060	.9055	.0050	.0591	.0906	.1575	9650	5600	1.41
	40.000	.013	90.000	.015	23.000	.127	1.500	2.30	4.000	42925	24910	1.41
6309-ZZ-22	1.7717	.0005	3.9370	.0060	.9843	.0050	.0591	40.0906	.1575	12000	7100	1.89
	45.000	.013	100.000	.015	25.000	.127	1.500	2.30	4.000	53378	31582	1.89
6309-2RS-22	1.7717	.0005	3.9370	.0060	.9843	.0050	.0591	.0906	.1575	12000	7100	1.89
	45.000	.013	100.000	.015	25.000	.127	1.500	2.30	4.000	53378	31582	1.89
6309-2RST-22	1.7717	.0005	3.9370	.0060	.9843	.0050	.0591	.0906	.1575	12000	7100	1.89
	45.000	.013	100.000	.015	25.000	.127	1.500	2.30	4.000	53378	31582	1.89
6310-ZZ-22	1.9685	.0005	4.3307	.0060	1.0630	.0050	.0787	.1181	.1772	14000	8500	2.45
	50.000	.013	110.000	.015	27.000	.127	2.00	3.000	4.500	62275	37809	2.45
6310-2RS-22	1.9685	.0005	4.3307	.0060	1.0630	.0050	.0787	.1181	.1772	14000	8500	2.45
	50.000	.013	110.000	.015	27.000	.127	2.00	3.000	4.500	62275	37809	2.45
6310-2RST-22	1.9685	.0005	4.3307	.0060	1.0630	.0050	.0787	.1181	.1772	14000	8500	2.45
	50.000	.013	110.000	.015	27.000	.127	2.00	3.000	4.500	62275	37809	2.45

